

DAMAGE CONTROL LAYOUT SKETCHES
SECTION 12 – PERSONNEL PROTECTION EQUIPMENT

SKETCH NO.	TITLE OF SKETCH	SHEET NO.
001	Firefighter's Ensemble and Self-Contained Breathing Apparatus (SCBA)	12-2
002	Repair Party Outfit	12-3
003	Repair Party Outfit and Self-Contained Breathing Apparatus (SCBA)	12-4
004	Aircraft Firefighting and Chemical, Biological & Radiological (CBR) Protective Clothing	12-5
005	Supplemental Emergency Egress Device (SEED) and SEED Charging Manifold	12-6
006	OCENCO [®] and SCOTT [®] Emergency Escape Breathing Devices (EEBDs)	12-7
007	Donning the OCENCO [®] Emergency Escape Breathing Device (EEBD)	12-8
008	Donning the SCOTT [®] Emergency Escape Breathing Device (EEBD)	12-9

ITEM	QTY	EQUIPMENT
1	1	POCKET
2	1 PR	FIREMAN'S BOOTS
3	1	FIREFIGHTER'S ENSEMBLE COVERALLS
4	1	SELF-CONTAINED BREATHING APPARATUS (SCBA)
5	1 PR	FIREFIGHTER'S GLOVES
6	1	DAMAGE CONTROL/FIREFIGHTER'S HELMIT WITH LINER/VISOR
7	1	ANTI-FLASH HOOD
8	VARIOUS	REFLECTIVE TAPE
9	1	QUICK FILL CONNECTION
10	1	HARNES, KEVLAR
11	1	QC BLOCK
12	1	E-Z FLOW REGULATOR
13	1	PRESSURE REGULATOR
14	1	CYLINDER

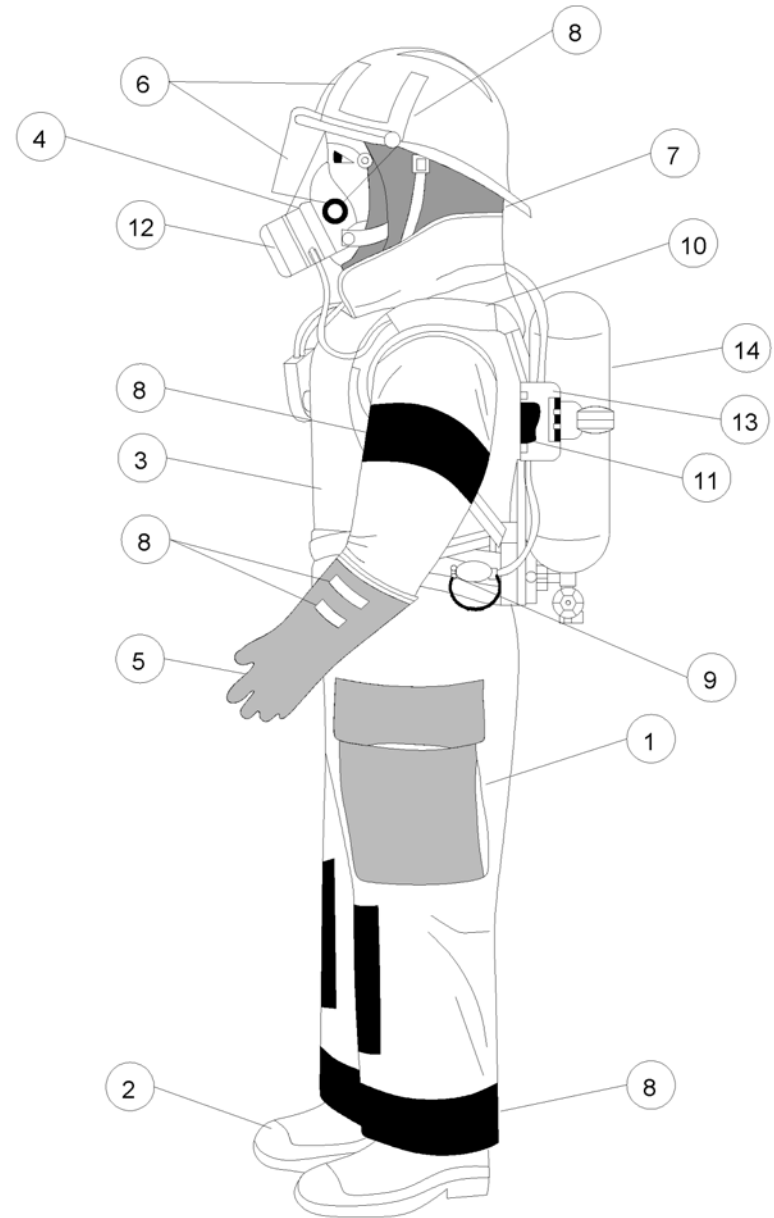

PERSONNEL PROTECTION EQUIPMENT - SKETCH #001
Firefighter's Ensemble and Self-Contained Breathing Appartus (SCBA)

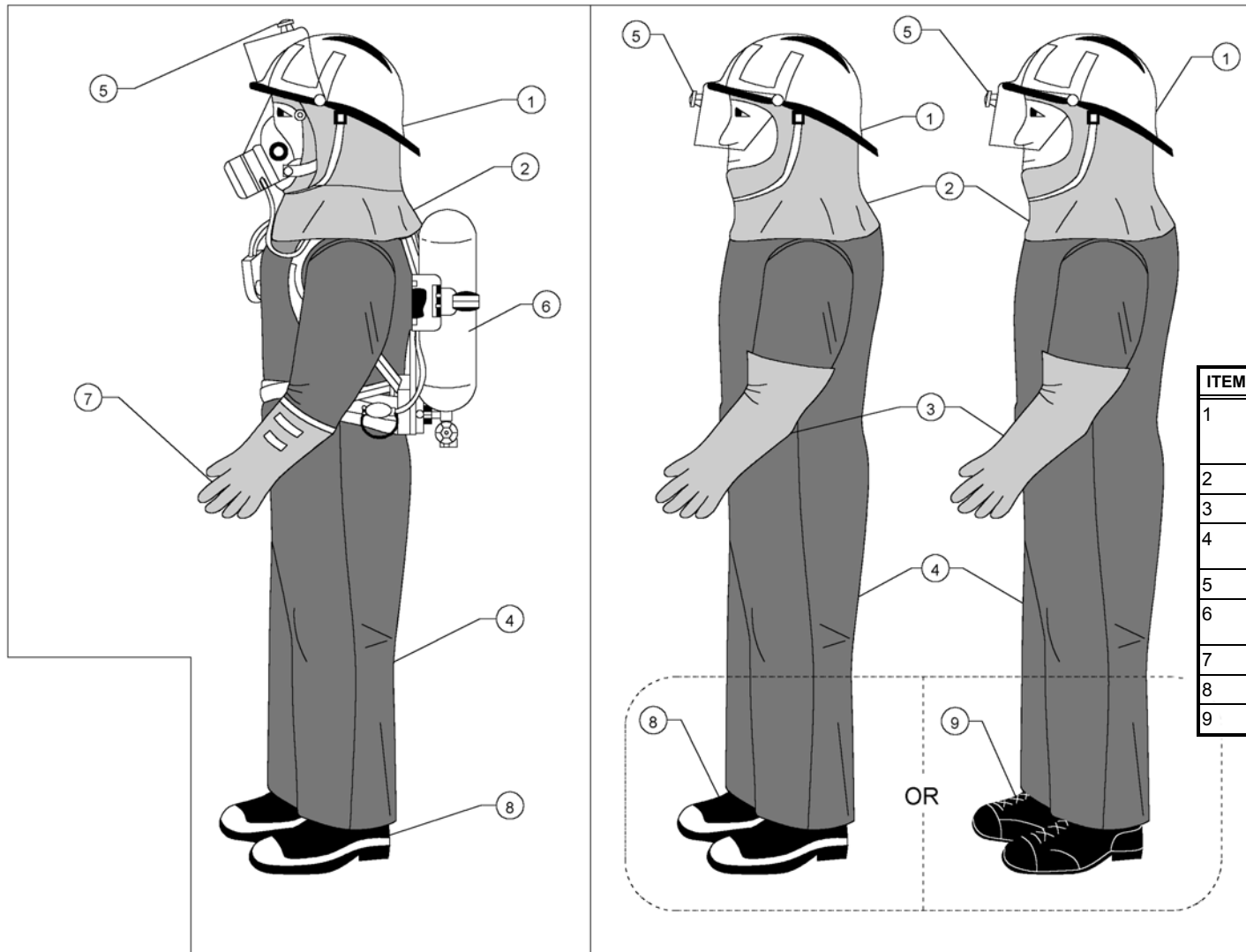

ITEM	QTY	EQUIPMENT
1	1	DAMAGE CONTROL/FIREFIGHTER'S HELMET WITH LINER/VISOR
2	1	ANTI-FLASH HOOD
3	1 PR	ANTI-FLASH GLOVES
4	1	FIRE RETARDANT COVERALLS (BLUE)
5	1	HEAD LANTERN
6	1	SELF-CONTAINED BREATHING APPARATUS (SCBA)
7	1 PR	FIREFIGHTER'S GLOVES
8	1 PR	FIREFIGHTER'S BOOTS
9	1 PR	STEEL TOE SHOES

PERSONNEL PROTECTION EQUIPMENT - SKETCH #002
Repair Party Outfit

ITEM	QTY	EQUIPMENT
1	1	DAMAGE CONTROL/FIREFIGHTER'S HELMET WITH LINER/VISOR
2	1	ANTI-FLASH HOOD
3	1	FIRE RETARDANT COVERALLS (BLUE)
4	1	HEAD LANTERN
5	1	SELF-CONTAINED BREATHING APPARATUS (SCBA)
6	1 PR	FIREFIGHTER'S GLOVES
7	1 PR	FIREFIGHTER'S BOOTS
8	1	QUICK FILL CONNECTION

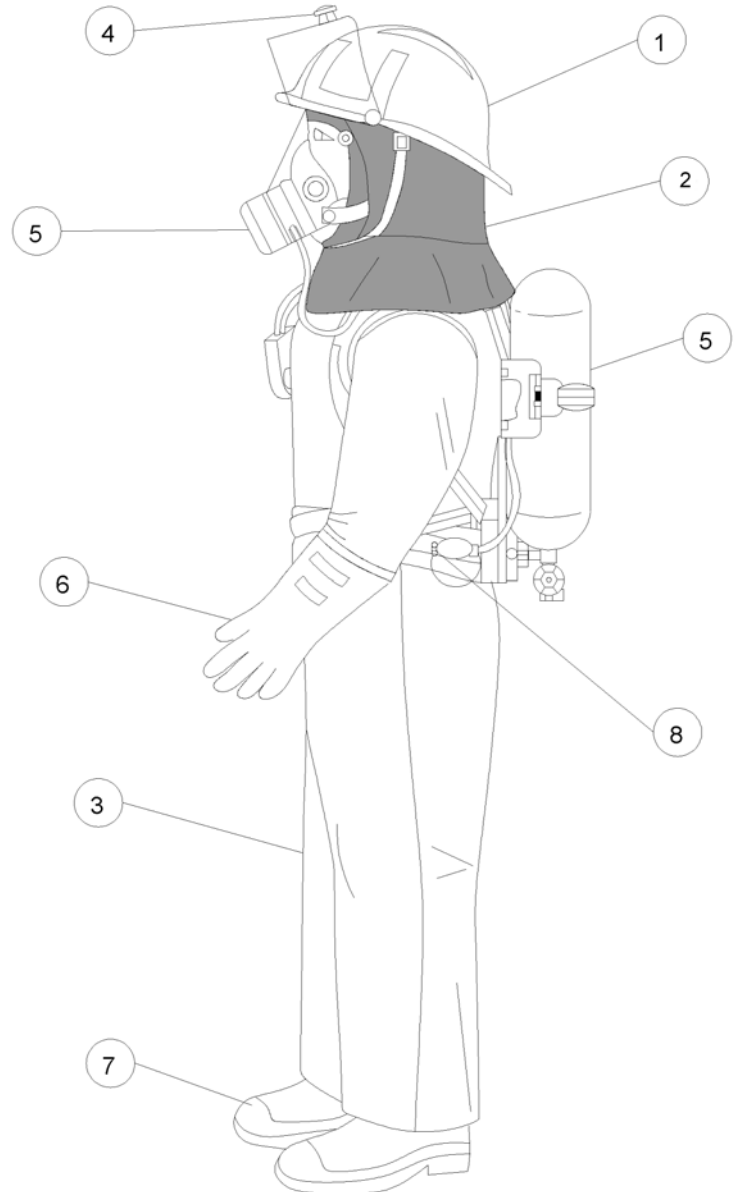

PERSONNEL PROTECTION EQUIPMENT - SKETCH #003
Repair Party Outfit and Self-Contained Breathing Apparatus (SCBA)

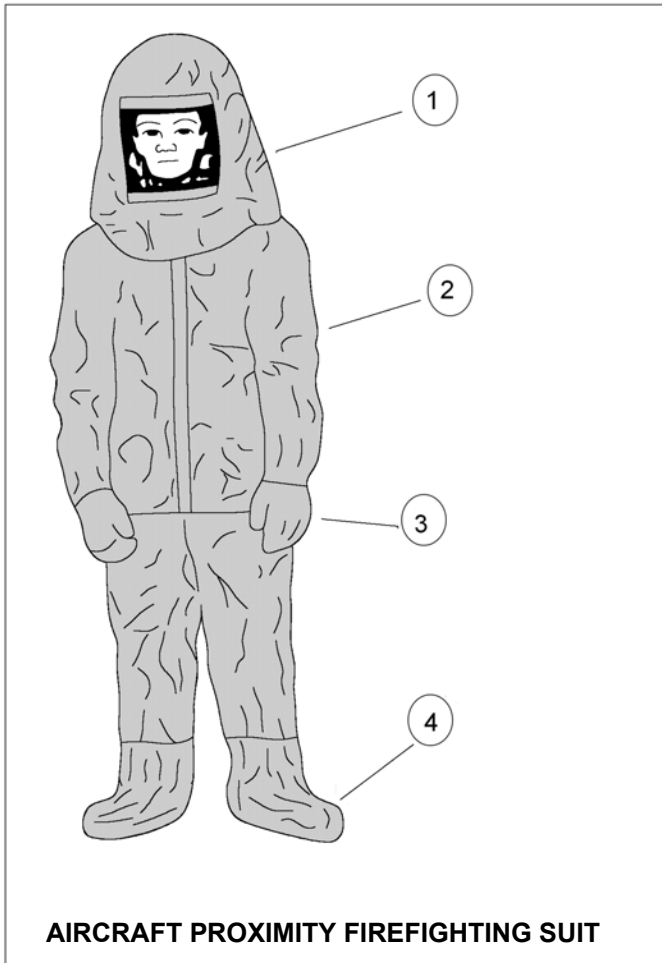

AIRCRAFT PROXIMITY FIREFIGHTING SUIT

ITEM	EQUIPMENT
1	HOOD
2	SUIT
3	GLOVES
4	BOOT COVERS

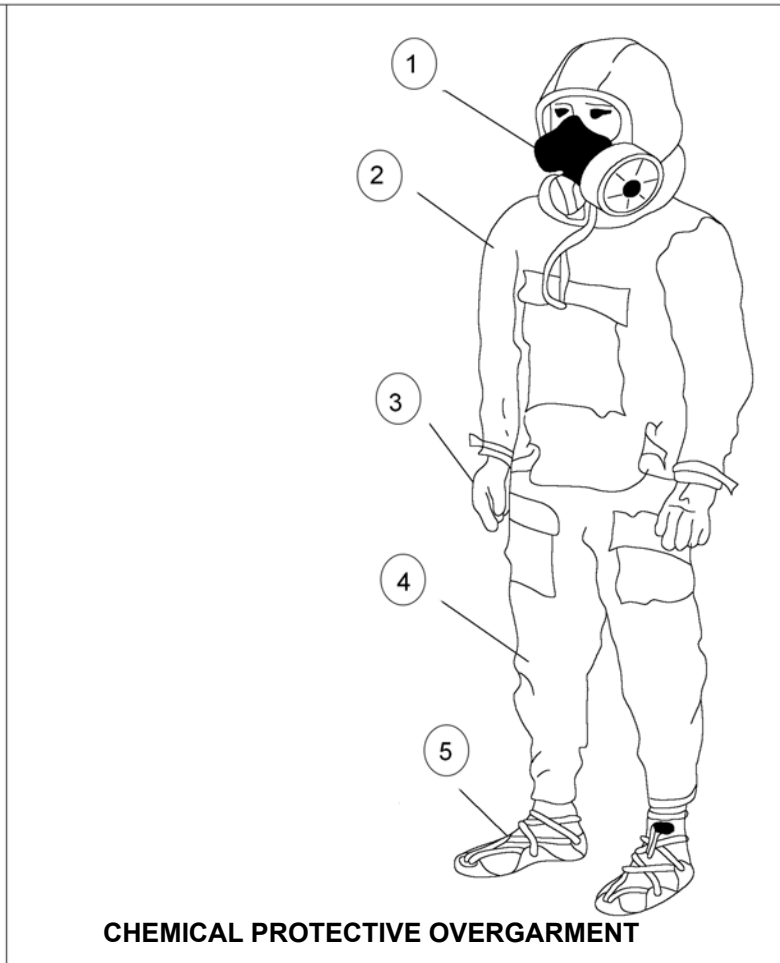

CHEMICAL PROTECTIVE OVERGARMENT

ITEM	EQUIPMENT
1	MCU-2/P
2	SMOCK
3	BUTYL RUBBER GLOVES
4	TROUSERS
5	CHEMICAL PROTECTIVE FOOTWEAR COVERS

PERSONNEL PROTECTION EQUIPMENT - SKETCH #004
Aircraft Firefighting and Chemical, Biological & Radiological (CBR) Protective Clothing

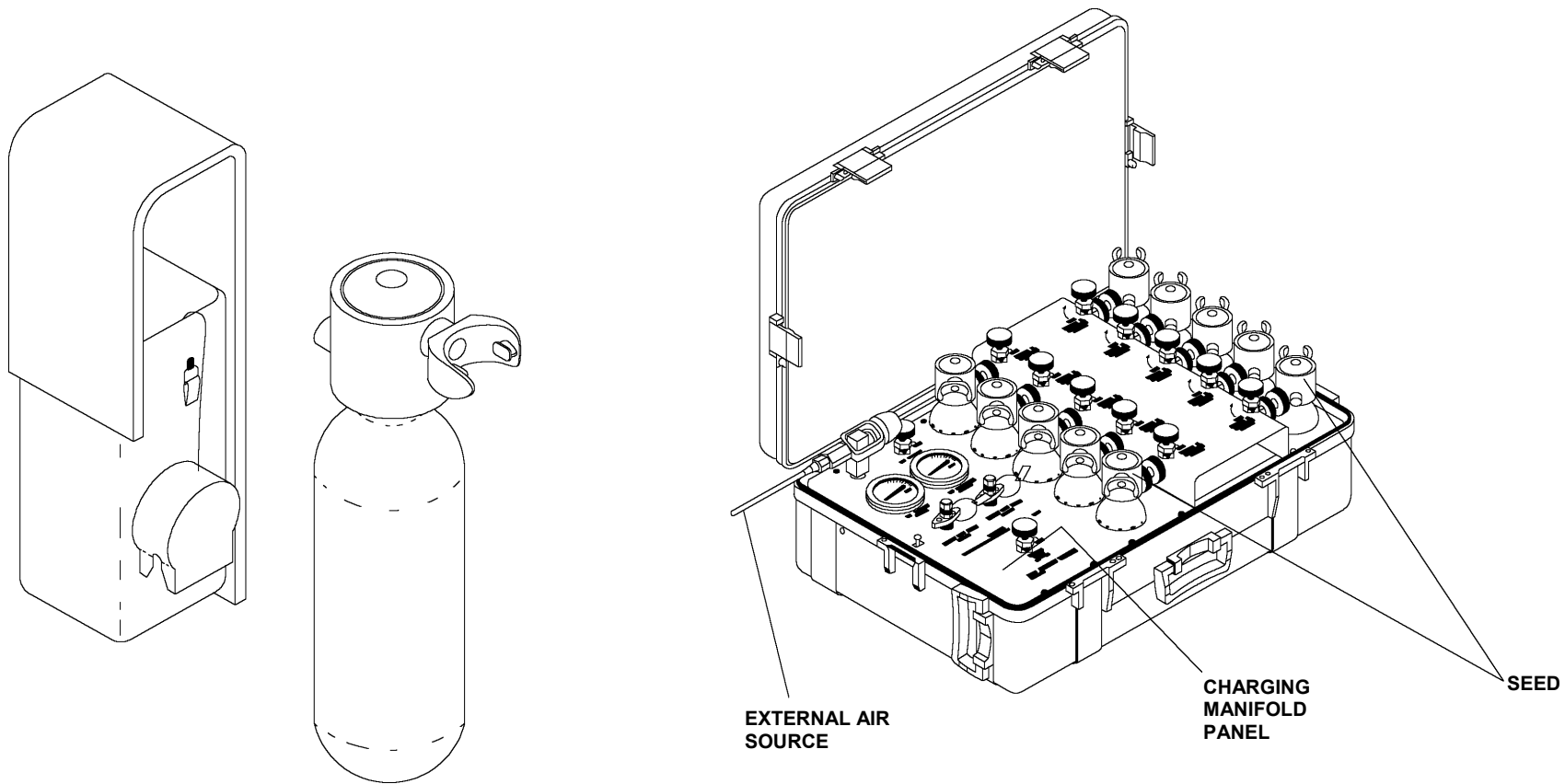

PERSONNEL PROTECTION EQUIPMENT - SKETCH #005
Supplemental Emergency Egress Device (SEED) and SEED Charging Manifold

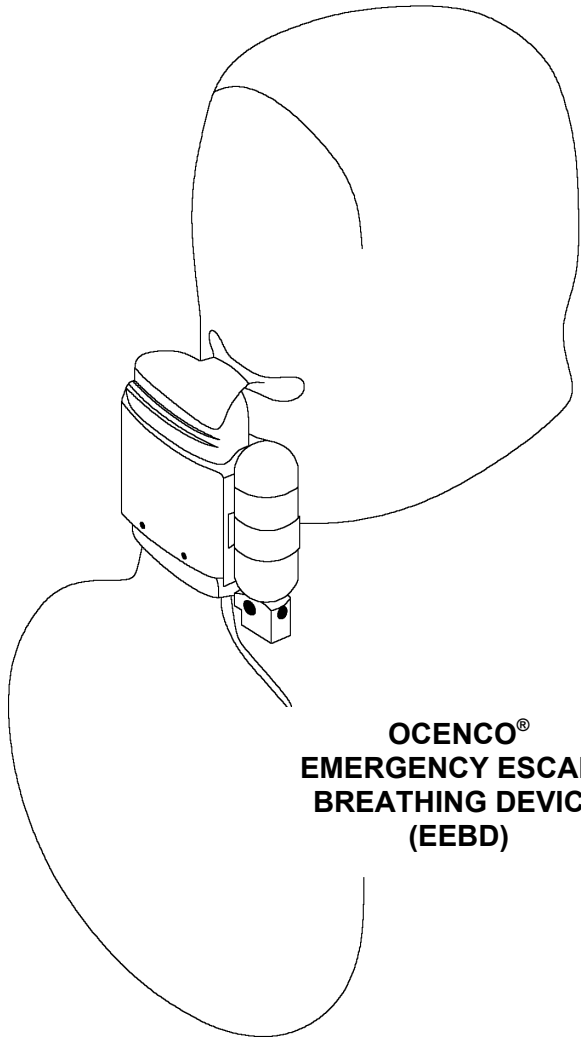

**OCENCO®
EMERGENCY ESCAPE
BREATHING DEVICE
(EEBD)**

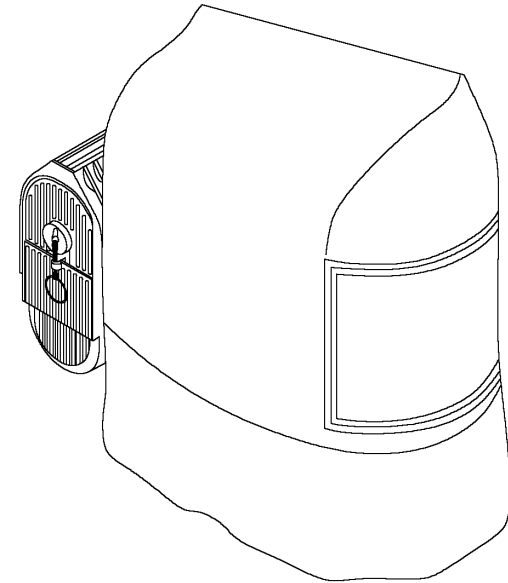

**SCOTT®
EMERGENCY ESCAPE
BREATHING DEVICE
(EEBD)**

**PERSONNEL PROTECTION EQUIPMENT - SKETCH #006
OCENCO® and SCOTT® Emergency Escape Breathing Devices (EEBDs)**

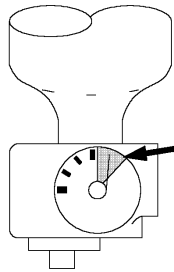

IF THIS GAUGE IS OUT OF THE GREEN ZONE, REMOVE FROM SERVICE.

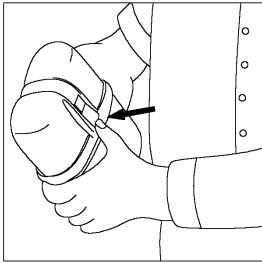
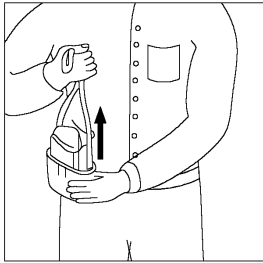
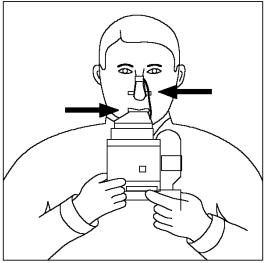
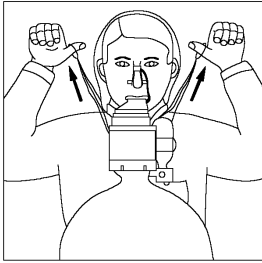
<p>1</p> <p>Remove unit from case.</p>	<p>2</p>  <p>Lift yellow lever and discard cover.</p>	<p>3</p>  <p>Remove unit by pulling yellow neck strap upwards.</p>
<p>4</p>  <p>Insert yellow mouthpiece and fit yellow nose clip.</p>	<p>5</p>  <p>Fit and adjust yellow neck strap and face shield.</p>	<p>6</p> <p>Escape.</p> <p>Remove EEBD when bag remains flat.</p>

PERSONNEL PROTECTION EQUIPMENT - SKETCH #007
Donning the OCENCO® Emergency Escape Breathing Device (EEBD)

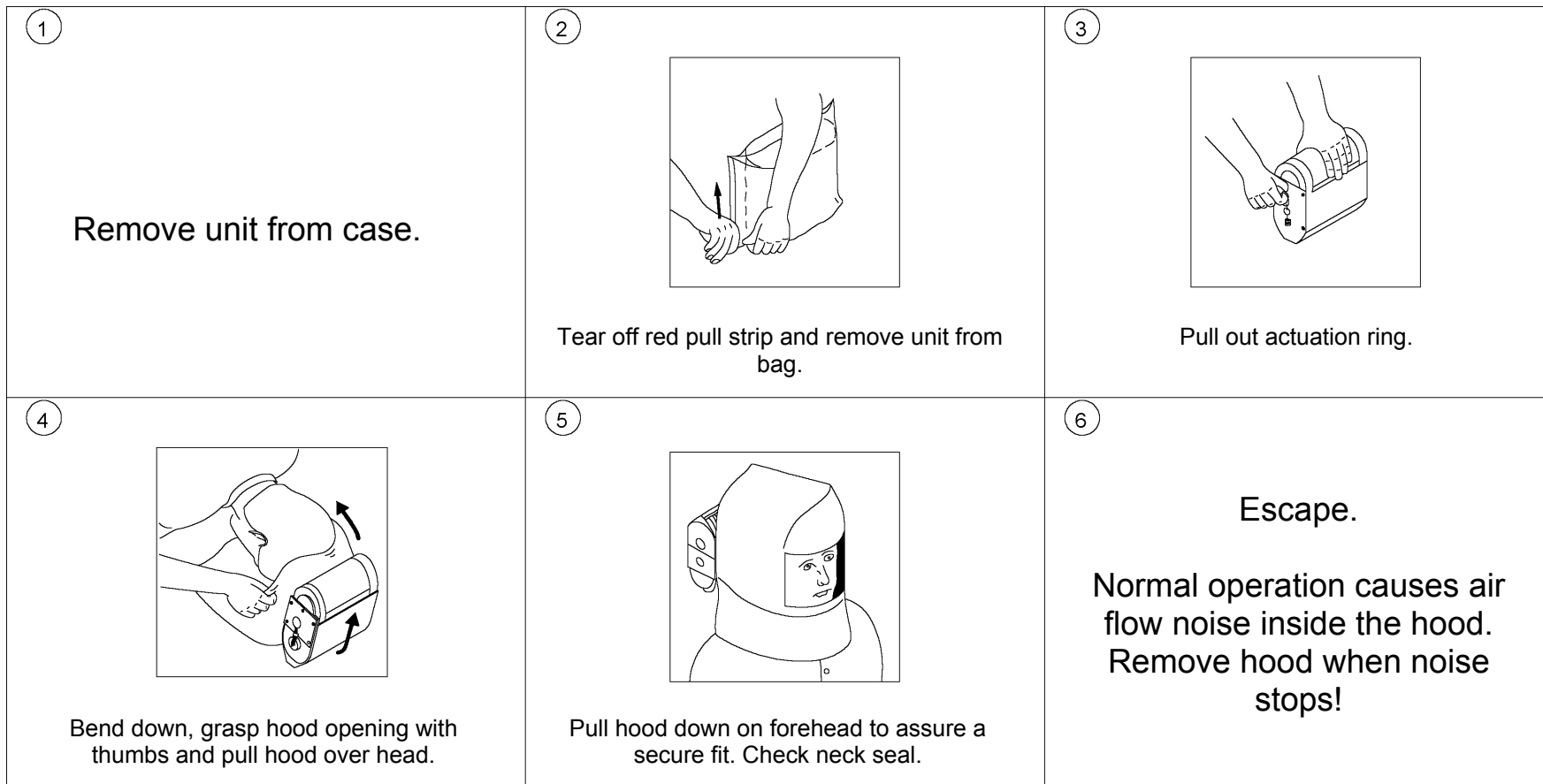

PERSONNEL PROTECTION EQUIPMENT - SKETCH #008
Donning the SCOTT® Emergency Escape Breathing Device (EEBD)